

# Gazelle Script Form

## Tennis Sports Wheelchair

90825



**To Order** Fill in the frame dimensions and features required. For variations describe in detail on a separate page. If you have any further questions contact us at the address at the bottom of the page.

**SEND FORM**  
If online, click here to send via e-mail

Date \_\_\_\_\_ Delivery details \_\_\_\_\_

Name \_\_\_\_\_

Address \_\_\_\_\_

Phone \_\_\_\_\_

Fax / Cell \_\_\_\_\_

Email \_\_\_\_\_

Required by \_\_\_\_\_  
(Delivery is normally 4-6 weeks from order confirmation)

Disability \_\_\_\_\_ Grading \_\_\_\_\_ Weight \_\_\_\_\_ Height \_\_\_\_\_ Shoe Size \_\_\_\_\_ T-Shirt Size \_\_\_\_\_

### MEASUREMENTS (Refer to diagrams)

**FRAME MATERIALS**  Aluminium (std)  Titanium 90825T

- |                                   |  |  |  |
|-----------------------------------|--|--|--|
| <b>A</b> Seat Width - Rear _____  | <b>F</b> Wheelbase<br>(centre of camber bar to centre of castor pivot) _____ | <b>M</b> Anti-Tip Position _____   | <b>R</b> <input type="checkbox"/> Binding Mounts<br>(seat rail mounted) <b>AD20315 (A)</b><br><b>AD20318 (T)</b> |
| <b>A</b> Seat Width - Front _____ | <b>G</b> Seat to Floor - Front _____   | <b>N</b> Camber _____  | <b>S</b> <input type="checkbox"/> Ergo Seat <b>AD10220 (A)</b><br><b>AD10221 (T)</b>                             |
| <b>A</b> Back Width _____         | <b>H</b> Seat to Floor - Rear _____  | <b>O</b> Foot-plate Width _____  | <b>T</b> Ergo Seat - Length _____  |
| <b>B</b> Seat Length _____        | <b>I</b> Balance Point _____   |  | <b>U</b> Ergo Back - Height _____  |
| <b>C</b> Back Height _____        | <b>J</b> Pivot Centres _____   |  | <b>V</b> Ergo Back - Angle _____   |
| <b>D</b> Back Angle° _____        | <b>K</b> Between Wheels _____  | <b>P</b> <input type="checkbox"/> Flexible Backpost Cap <b>AD20310</b>       | <b>STYLE</b>   |
| <b>E</b> Seat to Foot-plate _____ | <b>L</b> Foot-plate Position _____   | <b>Q</b> <input type="checkbox"/> Binding Mounts<br>(fixed back height only) | <b>W</b> <input type="checkbox"/> 3 wheel (excluding anti-tips)  |
|                                   |  |  | <b>X</b> <input type="checkbox"/> 4 wheel  |

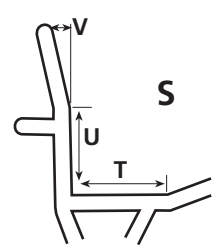
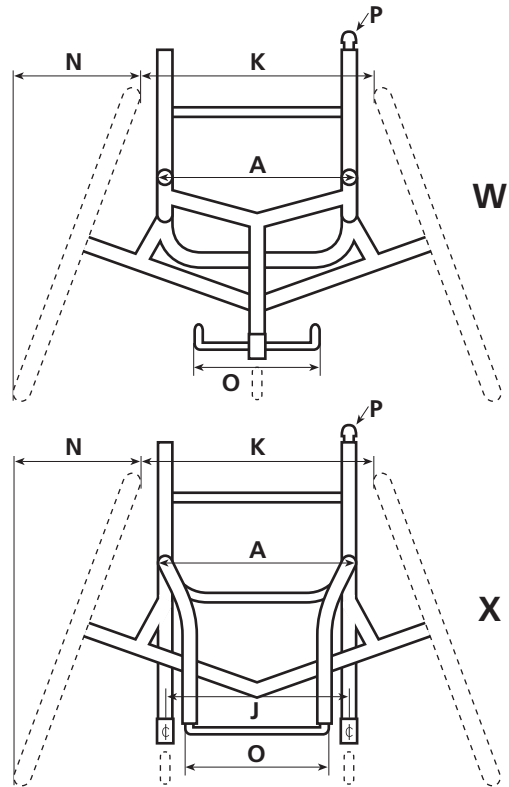
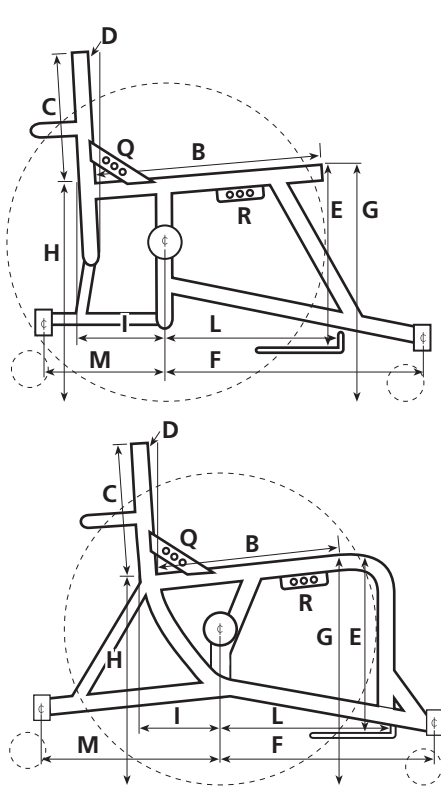

# Gazelle Script Form

## Tennis Sports Wheelchair

Name \_\_\_\_\_

**FOOTPLATE**

- No footplate     
  Alloy tube footplate (std)     
  Alloy footplate cover **AD11690**     
  Angle adj footplate **AD11520**

**ANTI-TIPS**

- Single swivel **AD15100 (A)**  
**AD15102 (T)**     
  Twin swivel **AD15150 (A)**  
**AD15151 (T)**     
  Single swivel custom height adjustable **AD15101**

**BEARINGS**

- Standard bearings     
  Melrose hybrid ceramic bearings **AD20400**

**CASTORS**

- Rollerblade 72mm     
  Rollerblade 76mm     
  Rollerblade 80mm     
  Other \_\_\_\_\_

**UPHOLSTERY**

- Seat sling (std)     
  Fixed width back (std)     
  No cushion     
  Cushion 3" **AD16203**  
 Seat sling wrap-around     
  Adjustable back upholstery     
  Cushion 1" **AD16201**     
  Cushion 1" (high density) **AD16221**  
 Solid seat **AD18030**     
 adjustable width/height **AD16050**     
 Cushion 2" **AD16202**     
 Cushion 2" (high density) **AD16220**

**SKIRT GUARDS**

- No skirt guards     
  Fabric skirt guards **AD16100**     
 Alloy skirt guards **AD16125 (A)**  
**AD16130 (T)** (height) \_\_\_\_\_  
(welded to alloy frame, bolted to titanium frame)  
 ABS rigid skirt guards **AD16111** (height) \_\_\_\_\_

**STRAPS, IMPACT GUARDS**

- Front hanger covers **AD16400**     
 Hip strap - webbing **AD16510**     
 Knee - ratchet **AD16351**  
 Back bar cover **AD16420**     
 Hip strap - ratchet **AD16550**     
 Leg strap **AD16330**  
 Foot strap - webbing (std)     
 Chest strap **AD45210**  
(measure around your chest and seat back)  
 Foot strap - ratchet **AD16350**

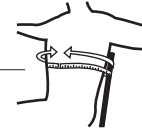
**ACCESSORIES**

- Wheel bag (black with choice of trim colour) **AD16780** (Choose your trim colour) **Bk R Bl Y Gr Pk Pu**     
 Custom Wheel Bag **AD16781**  
(describe below)

**ADDITIONAL NOTES**

(you can type here)

# Gazelle Script Form

Tennis Sports Wheelchair

Name \_\_\_\_\_

**WHEELS****TYRES****24"****24"**

- Spoked Wheels (std)
- Spinergy SL Wheels (24 spoke, black spokes only) **AD13410**
- Spinergy SLX Wheels (24 spoke, black spokes only) **AD13420**

- 24" x 1" Kenda Ironcap Blue (std)
- 24" x 1" Kenda Konstrictor (std)
- 24" x 1" Schwalbe Right Run **AD13740**

**25"****25"**

- Spoked Wheels **AD13060**
- Spinergy SL Wheels (24 spoke, black spokes only) **AD13410**
- Spinergy SLX Wheels (24 spoke, black spokes only) **AD13420**

- 25" x 1" Kenda Ironcap Blue (std)
- 25" x 1" Kenda Konstrictor (std)
- 25" x 1" Kenda Kaliente **AD13721**
- 25" x 1" Schwalbe Right Run **AD13740**

**26"****26"**

- Spoked Wheels **AD13060**
- Spinergy SL Wheels (24 spoke, black spokes only) **AD13410**
- Spinergy SLX Wheels (24 spoke, black spokes only) **AD13420**

- 26" x 1" Kenda Ironcap Blue (std)
- 26" x 1" Schwalbe Right Run **AD13740**

**PUSH-RIMS**

- Anodised alloy (std)       Rubber coated (red) **AD13845**       Vinyl coated **AD13830**

**PUSH-RIMS - POSITION**

- Standard       In close       Onto rim

**SPARE WHEELS as above**

- Spoked Wheel 24" **AD13507** (quantity) \_\_\_\_\_
- Spoked Wheel 25"/26" **AD13561** (quantity) \_\_\_\_\_
- Spinergy SL Wheel **AD13641** (quantity) \_\_\_\_\_
- Spinergy SLX Wheel 1/2" axle **AD13651** (quantity) \_\_\_\_\_

**TYRES, TUBES and AXLES on SPARE WHEELS**

- Tube fitted **AD13695** (quantity) \_\_\_\_\_
- Kenda Tyre fitted **AD13701** (quantity) \_\_\_\_\_
- Schwalbe Tyre fitted **AD13741** (quantity) \_\_\_\_\_
- Axle 1/2" **AD12508** (quantity) \_\_\_\_\_

**PUSH RIMS for SPARE WHEELS as above**

- Push-Rim Anodised **AD13858** (quantity) \_\_\_\_\_
- Push-Rim Rubber Coated (Red) **AD13846** (quantity) \_\_\_\_\_
- Push-Rim Vinyl Coated **AD99999** (quantity) \_\_\_\_\_

**EXTRA AXLES**

- Axles 1/2" **AD12514** (quantity) \_\_\_\_\_

**EXTRA BEARINGS**

- Steel R8 1/2" **AD20405** (quantity) \_\_\_\_\_
- Ceramic R8 1/2" **AD20407** (quantity) \_\_\_\_\_

**ADDITIONAL NOTES**

(you can type here)

# Gazelle Script Form

Tennis Sports Wheelchair

Name \_\_\_\_\_

**COLOURS**

- 27 Candy Blue
- 1 Royal Blue
- 72 Glass Blue
- 16 Candy Purple
- 48 Burgundy
- 83 Candy Raspberry
- 88 Fluro Pink
- 28 Candy Red
- 11 Flame
- 57 Super Hot Chilli
- 80 Candy Orange
- 71 Pure Orange
- 68 Crystal Yellow
- 73 Crystal Jade
- 89 Fluro Green
- 70 Candy Emerald
- 2 Hawthorn Green
- 17 Crystal Sapphire

**ATTENTION**

**THIS IS A GUIDE TO COLOURS ONLY, how colours appear on your monitor or when printed out may vary.**

Contact us if you require assistance or a colour sample.

This colour selection is for our aluminum frames only.

We do not recommend powder coating titanium.

Colour availability is subject to change without notice, contact us if you are concerned about the availability of your colour.

- 55 Silver Sparkle
- 12 Silver Orbiter
- 46 Chrome
- 42 Metallic Viper
- 30 Satin Black
- 61 High Gloss Black
- 62 Matt Black
- 63 Texture Matt Black
- 18 Clear
- Bead Blast** (titanium only)
- Custom Colour** (additional cost)



Description